

SPRINGFIELD Show Home



THE SPRINGFIELD 22X76 1672 sqft

Features Include:

- ◆ White Cabinets
- ◆ Italian White di Pesco Countertops
- ◆ Black Stainless Steel Appliances
- ◆ French Doors into Family Room
- ◆ 1/2 Bath in Utility Room
- ◆ Mansel Island in Kitchen
- ◆ Obsidian Package /Faucets/Hardware



The photos displayed of this home may be different from the actual home.



Jim Fradette

403.396.5047

jim@dynamicmodular.ca

8260 Chiles Industrial Avenue

Red Deer, Alberta

403.341.4422

Toll Free: 1.877.341.4422

www.dynamicmodular.ca

We Put Your Family First!



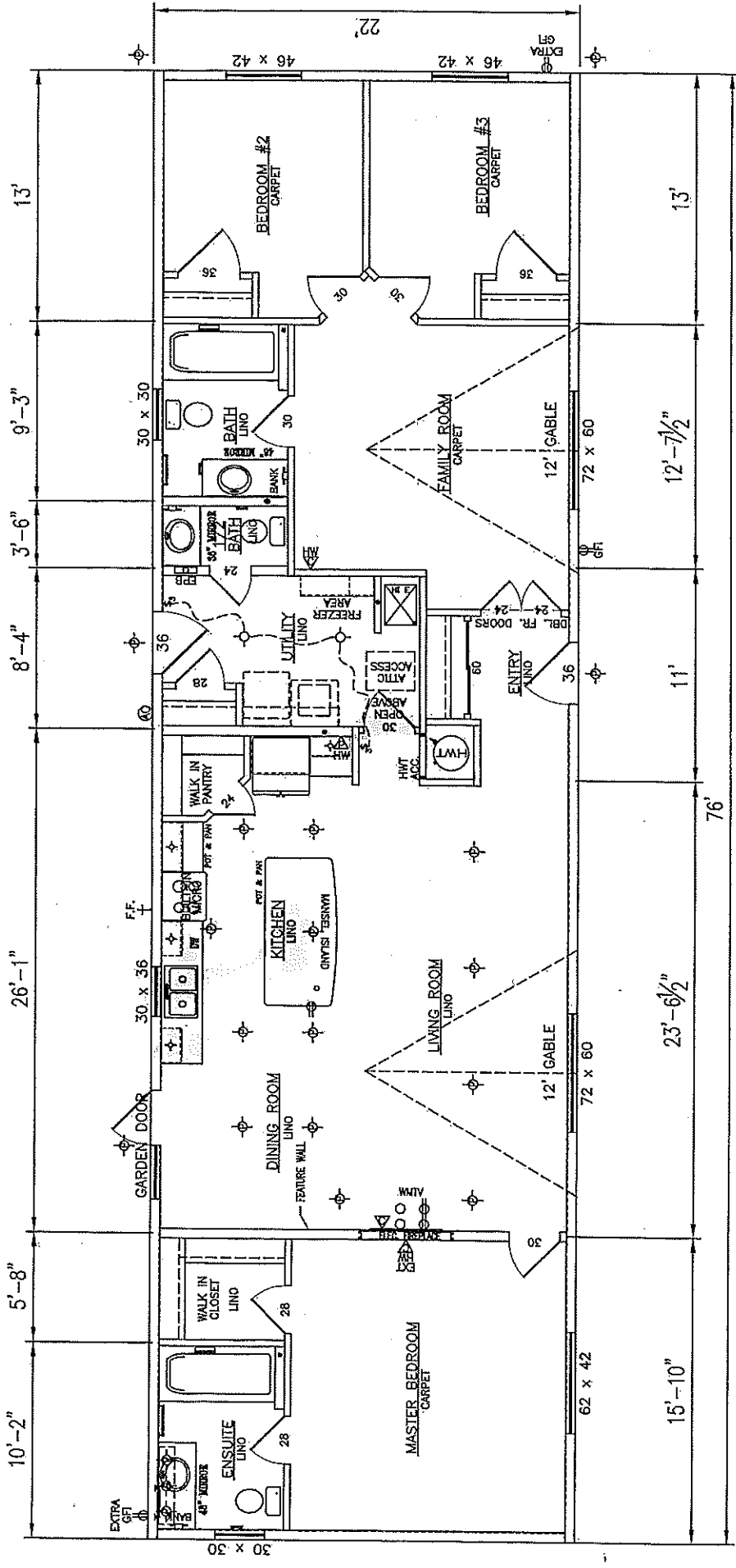



STANDARD FEATURES AND SPECIFICATIONS

CJN Series...22' Wide Homes



EXTERIOR

Colour coordinated metal fascia
Vinyl siding
4/12 pitch roof
Exterior GFI receptacle - front door
Exterior frost-free tap – kitchen sink
30-year architectural fiberglass shingles
7/16" roof sheathing
Residential eaves (3 sides)
Separate receptacle for heat tape
Engineered roof trusses
12" deep engineered I-joists at 16" o.c. floor system
3/8" wall sheathing on inside & outside of exterior walls
Insulation: R22 walls; R40 ceiling; R48 floor
2x6 side walls at 24" o.c. - 8' walls
19/32" T&G subfloor

DOORS

Insulated steel exterior doors, 36" front and rear
(where possible) with peepholes and deadbolts
Lever door handles
Storm doors – optional
Coach lights at all exterior doors

WINDOWS

LowE PVC windows and sills with screens
2" Venetian blinds on all windows

KITCHEN

Adjustable shelf in all cabinets – (2) upper and (1) lower
Double stainless-steel sink
Roller drawer slides
PVC cabinet doors
18 cu. ft. frost free refrigerator
30" electric range with clock and timer
2-speed range hood with light and fan
White kitchen appliances – black optional
Standard phone jack - kitchen area
Single lever faucet with vegetable sprayer
Upper corner cab – narrow reed glass

UTILITY ROOM

Plumbed and wired for washer/dryer
Natural gas high efficiency furnace
Dryer vent rough in
Electric hot water tank
Overhead solid shelf at washer/dryer area
Insulated lines in HWT cavity

BATHROOMS

Exhaust fan with humidistat in main bath
Exhaust fan in ensuite on separate switch
Towel bar and towel ring (most models) in each bath
Cosmetic box in main bath
Showerhead in all baths
Shower rod and shower curtain liner in all baths
GFI receptacle in all baths
Walled tub/shower with single lever pressure balanced faucet in all baths
Single lever faucets in all baths
Theatrical lights in all baths

INTERIOR

Decorative vinyl covered drywall
6 mil. vapour barrier includes switches and receptacles
Plush carpet in LR, MBR, Bedroom #2/#3/#4, FR
Quality vinyl floor covering
Cathedral ceilings in LR, DR, KIT
Solid shelving in all closets
Prefinished moulding
White embossed passage doors
4" ceramic tile backsplash at kitchen and vanities with tile edging
2x4 interior walls

MISCELLANEOUS

Electric smoke/CO detector(s)
Ceiling lights in all bedrooms
Wire only ceiling light in living room
100-amp service panel
Main electrical conduit through floor
White receptacles and switches
Light bulb package
Programmable thermostat
Airtight Protocol

ALL HOMES ARE BUILT TO MEET OR EXCEED CSA A-277 SPECIFICATIONS

**ENERGY ZONE UPGRADES MAY BE REQUIRED
HOME IS BUILT TO MEET ENERGY ZONE 7A**

ALL PRICES ARE F.O.B. LETHBRIDGE, AB

ALL PRICES DO NOT INCLUDE GST

**ALL PRICES DO NOT INCLUDE ASSOCIATION FEES
STANDARDS IN EFFECT AS OF JANUARY 19, 2021**

This is not a fully detailed specification. SRI Homes - Regent reserves the right to change specifications, designs, materials and suppliers without notice and without incurring obligation. Information contained herein is from data available at the time of printing.